

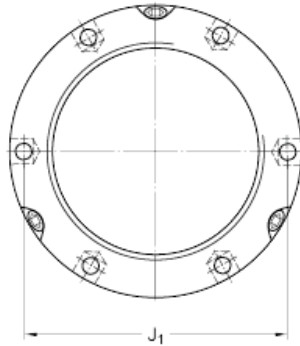

NTN bearing de Mexico, S.A.

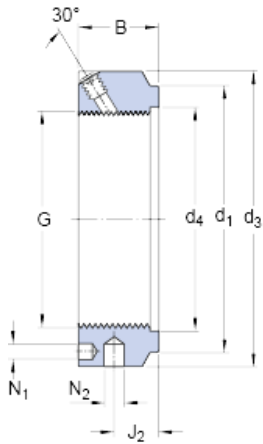

skf KMTA 38 Precision lock nuts with axial locking screws, Precision lock nuts

Bearing No. KMTA 38

KMTA 38 Bearing 2D drawings and 3D CAD models

G	M 190x3
d ₁	225 mm
B	32 mm
d ₃	240 mm
d ₄	192 mm
J ₁	224 mm
J ₂	17 mm
N ₁	8.4 mm
N ₂	10 mm
Axial static load carrying capacity	1280 kN
Mass	4.1 kg
Associated spanner (Hook spanner in accordance with DIN 1810)	B 230-245
Grub (set) / Locking screw size	M 10
Recommended tightening torque	35 N · m